

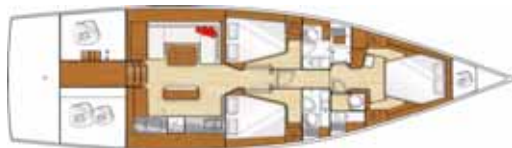

3 cabins - 3 wash rooms

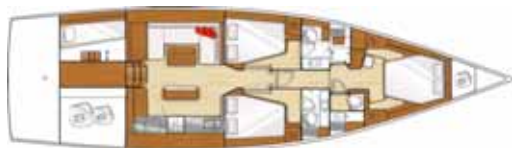

3 cabins - 3 wash rooms - 1 Occasional cabin (optional)



GENERAL SPECIFICATIONS

• L.O.A	17,20 m	56'5"
• Hull length	16,80 m	55'1"
• L.W.L.	15,93 m	52'3"
• Beam	4,97 m	16'4"
• Deep draught (min)	2,35 m	7'9"
• Deep ballast weight	4 900 kg	10,800 lbs
• Shallow draught (min)	1,80 m	5'11"
• Shallow ballast weight	5 500 kg	12,122 lbs
• Air draught (max)	23,91 m	78'5"
• Light displacement (EC)	18 560 kg	40,906 lbs
• Fuel capacity (max)	830 l	219 US Gal
• Freshwater capacity (max)	970 l	256 US Gal
• Engine power	POD 120	POD 120

ARCHITECT / DESIGNERS

- Naval Architect : Berret Racoupeau Yacht Design
- Interior design : Nauta Design

EC CERTIFICATE

- Category A - 10 persons
- Category B - 11 persons
- Category C - 16 persons

STANDARD SAIL LAYOUT AND AREA

• Mainsail (classic)	74 m ²	796 sq ft
• Genoa (105 %)	78,5 m ²	845 sq ft
• Asymmetric spinnaker	208,3 m ²	2,242 sq ft
• I	21,25 m	69'9"
• J	7,31 m	24'
• P	20,2 m	66'3"
• E	6,35 m	20'10"



STANDARD EQUIPMENT

CONSTRUCTION

- Design made following European Directive requirements and according to EC certification
- Monolithic hull design in polyester
- Monolithic structural counter moulding laminated and bonded to the hull
- Deck in balsa and glass fibre sandwich covered in «diamond point» type non-slip surface
- Hull/deck joint screwed, bonded and covered with a single solid wood rubbing strake screwed in place
- Cast iron keel bonded and bolted using stainless steel bolts and counter plate
- Twin underhung rudders with stainless steel stock
- White coloured hull - Grey metallic livery

DECK EQUIPMENT

RIGGING

- Standard mast SELDEN 9/10 electro-polished aluminium installed on the deck, 2 levels of advanced cross trees - MDS roller slides
- Anodised aluminium boom
- Discontinuous stainless steel standing rigging
- Backstay: Bridle
- Rigid kicking strap with tackle
- Genoa furling system with drum on the deck
- 2 Blocks "STANDUP" on mainsheet arch
- 2 genoa tracks with piston adjusted traveller cars - 2 Genoa sheet return blocks
- Rigging run back to cockpit (except boom topping lift)
- Complete running rigging: Main halyard, genoa halyard with clutch on mast and cleat, Boom topping lift with cleat on mast, Mainsheet, 2 Genoa sheets 2 fast reefing ropes, 1 manual reef
- 12 Jammers, and other control lines
- 2 rope boxes

WINCHES

- 2 Self-tailing genoa sheet winches (H60.2 STC)
- 2 Self tailing coachroof winches (H46.2 STC to starboard, H50.2 STC to port)
- 2 Winch handles SpeedGrip
- 2 Winch handle boxes

SAILS

- Dacron furling genoa
- Full batten dacron mainsail with Beneteau logo
- Lazy Jack and Lazy Bag in Natural colour

MOORING - ANCHORING

- Self-draining chain locker
- Stainless steel bow fitting 2 rollers - Stainless steel bobstay
- 12 V - 1500 W Vertical electrical windlass - Remote control
- 8 Stainless steel mooring cleats - Stainless steel deck line protection

SAIL LOCKER

- Access through deck hatch
- Stainless steel ladder
- Hatch giving access to chain locker

SAFETY ON DECK

- 1 Open stainless steel forward pulpit
- 2 fixed stainless steel pushpits
- Stainless steel backrests fitted to helm seats
- 1 Ring lifebuoy bracket
- 1 Outboard engine bracket
- Double guardrail and stainless steel stanchions - Opening to port and to starboard in guardrail
- 2 Stainless steel handrails on deck
- 2 Stainless steel handrails on fixed arch

COCKPIT

- Self-draining cockpit
- 1 Port cockpit locker (Access to technical space or Occasional cabin (optional))
- 1 Starboard cockpit locker (Access to technical space)
- Gas locker beneath starboard cockpit seat
- Natural solid wood slatted cockpit benches
- 1 Liferaft locker in cockpit sole
- 2 Steering wheel consoles: Stainless steel steering wheels - 900 mm / 2'11" diameter - leather covered - Stainless steel handrail - navigation instrument stand (optional instruments) - Glass holder - 2 Steering compass on binacle
- 2 Deck holes for access to tiller system
- Backrests to helm Chine Grey
- 1 Tiller
- Engine throttle and control panel to starboard
- Wooden cockpit table with leaf to starboard which can be transformed into sun-bathing area
- 1 Fixed composite arch
- 2 waterproof loudspeakers on fixed arch
- Cockpit lighting integrated in fixed arch
- 1 Glazed companionway hatch drops into cockpit sole - manually operated
- 2 Fixed windows to the aft of the coachroof

AFT TRANSOM

- Retractable transom to cockpit
- 2 Height-adjustable helmsman's seats
- Natural solid wood decking on sun deck
- 1 Stainless steel swimming ladder - solid wood steps - folds into locker
- 1 Hot and cold cockpit shower
- 1 Shore power socket
- 2 wet lockers on skirt
- Transom protector for raising the tender

INTERIOR

- Fruitwood Apli joinery or Alpi Fruitwood / lacquered white - Saloon / Galley (optional)
- Light oak laminate floors
- Bulkheads upholstered in vinyl fabric
- Fabric upholstery in the saloon
- Marine mattresses in the cabins

COMPANIONWAY

- Headroom: 1,99 m / 6'6"
- Wooden companionway with cold-moulded 3 steps
- 2 Leather covered stainless steel handrails

PORT SALOON

- Headroom: 1,98 m / 6'6"
- U shaped saloon bench
- Saloon table in only *1 piece, Varnished wood top with inlay, Aluminium legs.
- 1 central unit with folding bench seat - Stowage - Bar
- Cubby hole lockers and storage along the hull, Storage under bench seats
- 1 Hull porthole with curtain
- 1 Fixed deck house side window with concertina blind
- 1 Fixed wrap-around window to cockpit + Blind
- 1 flush deck hatch with blind / Mosquito net

CHART TABLE

- Control console with flap - glove boxes - Storage - Moulded wood beading
- Navigator's seat with (15°) tilting cushion to compensate for heel
- Electrics panel
- Navigation instrument panel (without instruments)
- Radio CD player / Stereo MP3 - 2 Loud speakers
- Battery switch panel + Breaker panel

GALLEY - STARBOARD

- Headroom: 1,97 m / 6'6"
- Lengthways kitchen
- Synthetic resin worktop Grey
- 1 Sink with 2 rectangular bowls, in Grey synthetic resin
- 1 Mixer tap cold water / hot water
- 1 Gas cooker 2 hobs, Stainless steel oven on mountings
- 1 Fridge 200 l, ice-cube tray, front and top-opening
- 1 Cool box 100 l, top opening
- Cupboards - Drawers - equipped lockers
- 1 Hull porthole with curtain
- 1 Fixed deck house side window with concertina blind
- 1 Fixed wrap-around window to cockpit + Blinds
- 1 flush deck hatch with blind / Mosquito net

FORWARD CABIN

- Headroom: 1,94 m / 6'4"
- Central double bed (1,70 m / 5'7" - 1,17 m / 3'10" - 2,03 m / 6'8") - Slatted bed base
- Wardrobe, Cupboard, Shoe cabinet
- Leather-topped dressing table with removable seat
- Mirrors
- 2 Hull portholes with curtain
- 2 Opening deck hatches with blind / mosquito nets

FORE WASHROOM

- Separate shower to port
- Headroom: 1,93 m / 6'4"
 - Private access via glazed door
 - Mirror - Cupboard
 - shower mixer tap hot / cold water
 - 1 flush deck hatch with blind / Mosquito net

Separate WC, to starboard

- Headroom: 1,94 m / 6'4"
- Manual marine toilet
- Washbasin - Synthetic resin worktop - Mixing tap hot water / cold water
- Mirror
- Toilet accessories
- Cupboard - Cubby hole locker
- 1 flush deck hatch with blind / Mosquito net

CABINS - PORT AND STARBOARD

2 Cabins each with:

- Headroom: 1,97 m / 6'6"
- Sliding entrance door
- Double bed (1,56 m / 5'1" - 1,00 m / 3'3" - 2,00 m / 6'7") - Slatted bed base
- Hanging locker - Cubby hole lockers - Drawers
- Mirror
- 1 Hull porthole with curtain
- 1 Opening deck hatch with shutter / Mosquito net

HEADS VERSION - PORT AND STARBOARD

2 Each washroom containing:

- Headroom: 1,94 m / 6'4"
- Private entrance through cabin
- Separate moulded shower, shower mixer tap hot / cold water
- Manual marine toilet
- Washbasin - Synthetic resin worktop - Mixing tap hot water / cold water
- Mirror
- Toilet accessories
- Cupboard and cubby hole
- 1 Opening deck hatch with shutter / Mosquito net

OCCASIONAL CABIN (OPTIONAL) - In place of the sail hold (Port side)

Access through the cockpit locker

- Headroom: 1,18 m / 3'10"
- Solid wood sliding ladder
- Marine mattress
- 1 Opening porthole
- 1 Opening hatch

ENGINE

- Diesel Engine Yanmar POD 120 Dock & Go
- Engine control - Starting - Control panel in cockpit
- Engine compartment: Foam soundproofing - Ventilation: 1 air intake and 1 pressured air outlet
- 1 Alternator 12 V / 80 Ah
- 1 Rotation moulded diesel tank (415 l / 110 US Gal in the saloon) - Electronic gauge - Low level alarm - 1 Deck filler
- Filters: Sea water - Diesel - Decanter
- Fixed three blade propeller
- Engine access via companionway and machinery space (opening with gas piston)

ELECTRICITY

- 12 V circuit - 220 V circuit
- 2 service batteries (2x140 Ah) - 1 Engine battery (110 Ah)
- 1 40 Ah Battery charger - 1 220V shore power - 1 Charge divider
- Electrical panel (12 V / 220 V) (Circuit breakers - Voltmeter - Water gauge - Fuel gauge - Battery warning - Fuel warning)
- Standard equipment: Sockets 220V
- Interior lighting: Halogen ceiling lights, Reading lights
- Outside lighting: 1 Forward and aft navigation lights - 1 Engine navigation light / Crosstree light forward of mast - 1 Mooring light on masthead - 1 Deck light
- Wire runs for options cables

PLUMBING

- 3 Roto moulded freshwater tanks (3 x 200 l / 3 x 53 US Gal) - Saloon / Side cabins - Separate fillers - Tank selection with ¼ by-pass valves
- Pressurised electric water pump - Accumulator tank - Inline filter
- 40 L / 11 US Gal Electric water heater (Operation off engine or on 220 V electrical system)
- 1 80 L / 21 US Gal rigid black water holding tank in port head compartment
- Electrical shower drain pumps
- 2 Electric bilge pumps - 1 Manual bilge pump
- 1 Electric ice box drain pump

GAS

- Gas bottle box in the cockpit (1 or 2 bottles, according to model)
- Pressure reducing valve and safety tap

TRIM LEVEL

	INSPIRATION	SENSATION
Electronic - 2 Displays (colors) TFT ST70 RAYMARINE (Loch, Speedometer, Depth sounder, Windvane anemometer)	■	■
Electronic - Multifunction touchscreen E120W - Interior	■	■
Electronic - Multifunction touchscreen E90W - Outside	■	■
Cockpit sole natural solid wood	■	■
Galley: 12 V Freezer compartment in 100 L Top-opening icebox	■	■
4 Opening ports in galley and saloon windows	■	■
2 service batteries (2 x 140 Amperes x 12 V) + 40 amperes Additional battery charger	■	■
LED: Outside and inside lighting (except deck light)	■	■
Indirect LED lighting under high cupboards	■	■
Shore freshwater supply	■	■
Galley: Freshwater purifier	■	■
1 Port electric coachroof winch H50.2 STECH	■	■
Inner forestay chainplate	■	■
Multimedia system: Radio CD/DVD PIONEER - Speakers BOSE ACOUSTIMASS® 3 - Outside loudspeakers SONY	■	■
Motorised glazed folding companionway door in cockpit floor - 2 Remote controls	■	■
Galley: Extractor hood		■
Galley: Seawater foot pump		■
Galley: Deluxe 3 burners hob, stainless steel oven and grill		■
Pump for deck washing		■
Chart table: Universal recharging station (Cellphone, MP3, GPS, PDA, etc...)		■
Inverter 2 000 KVA - 12 V / 220 V		■

OPTION PACK

	DOCKING	EASY DOCKING	ELECTRONIC RAYMARINE
Bow thruster		■	
2 Steering wheels + Console white PVC covers	■	■	
Windlass control in cockpit with chain counter to starboard	■	■	
4 Moorings, Anchoring, 8 Fenders	■	■	
Starboard steering console: Multifunction screen E90W colour RAYMARINE (GPS - Chart plotter - Chart plotter - Without chart - Cartography Europe included)			■
PC interface RAYMARINE			■

VERSION

	DOCK & GO
Engine YANMAR Diesel Dock & Go POD 120	■
Swivel Sail Drive base	■
Joystick	■
Vessel Management Unit (VMU)	■
Bow thruster	■
Auto pilot	■

OTHER OPTIONS

NAVIGATION ELECTRONICS RAYMARINE

- Pilot Raymarine ST 70 (Included gyrocompass)
- Autopilot remote control, Wireless instruments repeater SmartController
- High definition digital radar (radome only)
- Transmitter / Receiver AIS 650 + VHF RAYMARINE 49E

RIGGING - SAIL

- Flag halyards
- Asymmetric spinnaker + Rigging Code 0
- Self-tacking jib hardware
- Fore stay sail furler + Staysail Hydranet
- Hydranet sail for classic mast (In replacement of standard)
- Removable forestay
- Electropolished mast furling system with main sail
- Code 0 on furler
- Easy Sail for classical mast (Genoa traveller adjustment from cockpit, Clutches on genoa sheet blocks, Hydraulic regulation of the backstay)
- Easy Sail for mast with in-mast furling (Genoa traveller adjustment from cockpit, Clutches on genoa sheet blocks)

HULL - DECK - COCKPIT

- Electric genoa sheet winches H60.2STCEH
- Starboard electric coachroof winch H46.2STCEH
- 3 retractable blades propeller Dock & Go
- GRAPHITE Coachroof sprayhood
- GRAPHITE Cockpit Bimini
- CHINE GREY / STRIPE GREY outside upholstery
- High comfort outside upholstery
- Storm Grey hull
- Metallic hull paint
- Windex Windvane
- Solid wood slatted catwalks
- Arch on transom
- Cradle - Davits with solar panels + Wind generator
- Starboard wood cockpit table with electrical up/down system - White PVC protective cover
- Port cockpit table with foldaway seat

INTERIOR EQUIPMENT

- Water maker 60 l/h / 16 US Gal/hour 12 V/220 V
- Extra water tank (330 liter / 87 US Gal)
- 7 kVA 220 V / 50 Hz Generator
- All-electric galley
- 220V Microwave oven
- 220V Ice maker
- Washer dryer 220 V
- 220 V Dishwasher - 6 persons
- Water system heating
- Chilled water air-conditioning unit 220V
- White-lacquered doors - Saloon / Galley
- Deluxe folding saloon table on electric leg with up/down control
- Electrically-operated saloon window blinds
- Removable blind entrance door
- Removable extra table
- Double berth in saloon
- Safe
- Leather-covered chart table and console unit in the saloon
- Ivoire Complete carpet
- Additional holding tank 80 l / 21 US Gal - (For manual WC)
- Electric toilet + Rigid tanks
- Additional diesel tank (415 l / 110 US Gal in the saloon)
- TV Antenna
- TV LED 22" folding + DVD and MP3 player in master cabin
- TV LED 32" folding + Player DVD-MP3-CD in the saloon

OTHER LAYOUT VERSIONS AVAILABLE

OCCASIONAL CABIN

- Port aft
- Access through the cockpit locker - Opened by gas cylinder
- 1 Single berth
- 1 Opening porthole
- 1 hinged plexiglass panel in the cockpit side

